

SEISMIC SAFETY OF SAN FRANCISCO PRIVATE SCHOOLS



PEER Internship Program – Summer 2013

Undergraduate Intern: Julia Pavicic, Gonzaga University
Intern Mentor: Laurence Kornfield, City and County of San Francisco
University of California Berkeley



Motivation and Introduction

In California, the laws that govern private school buildings do not require the same seismic safety standards as public school buildings.

This is a huge problem in San Francisco because about one third of the attend private schools. Most private school parents are misinformed about the earthquake safety of the school their child attends. Little information is known about charter schools in San Francisco, so they are being categorized with private schools when concerned with seismic safety.

Methods

The City and County of San Francisco, through their CAPSS project, have a private school working group to collect information on each private school and charter school. This information was found mostly using school websites, the AB300 list, historic Sanborn maps, and building permit records. Within the working group is the private school structural committee, which uses the building data provided to estimate the earthquake safety of each school.

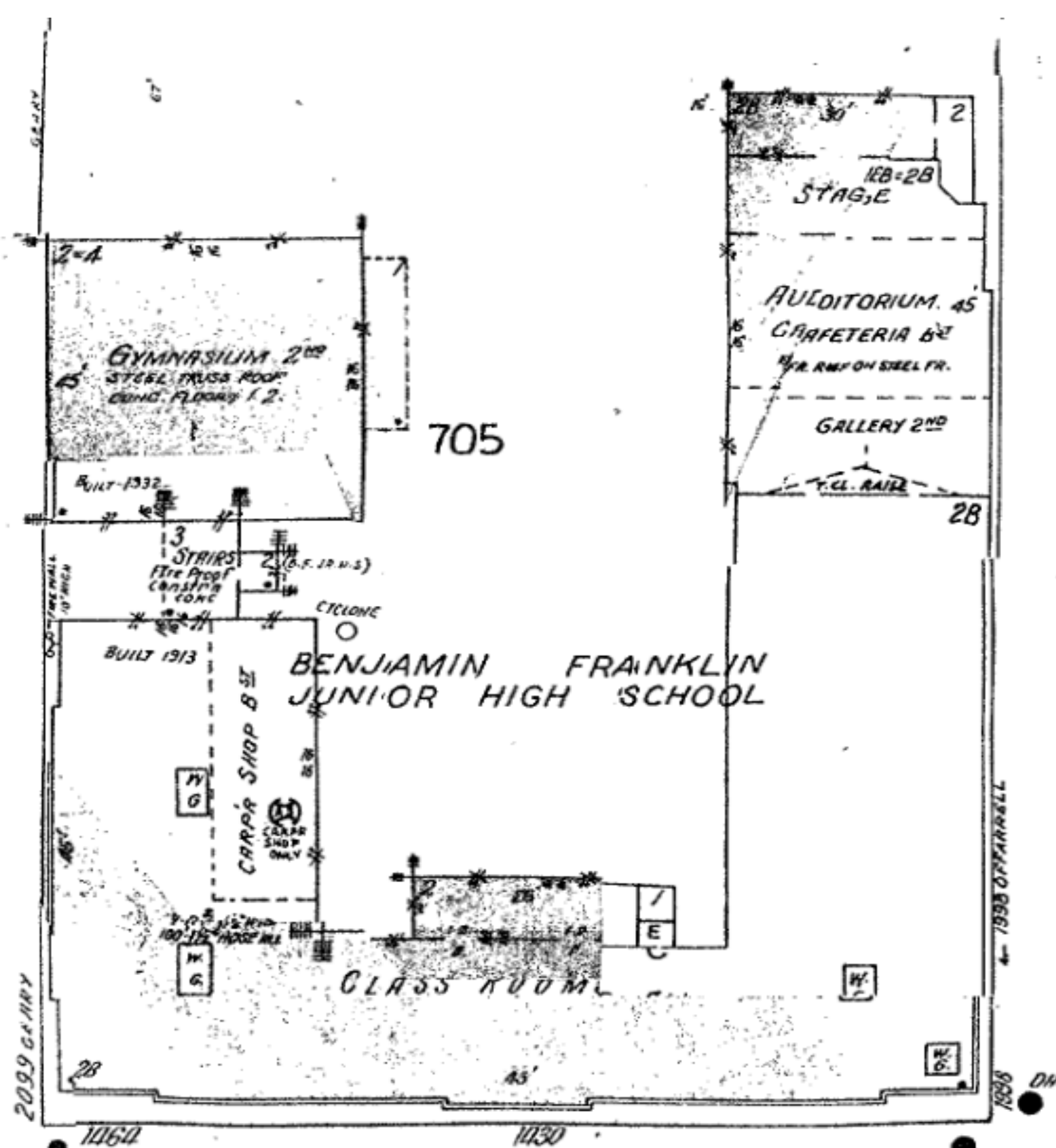

Sanborn maps are used to identify the gravity systems of a building as well as the year the building was erected.

Results

The research on private and charter schools is still ongoing. However the data thus far confirmed the belief private schools are not up to the same seismic safety standards as public schools. *The AB 300 identifies suspect unsafe public school buildings.* The survey was applied to private schools to compare private schools and public schools.

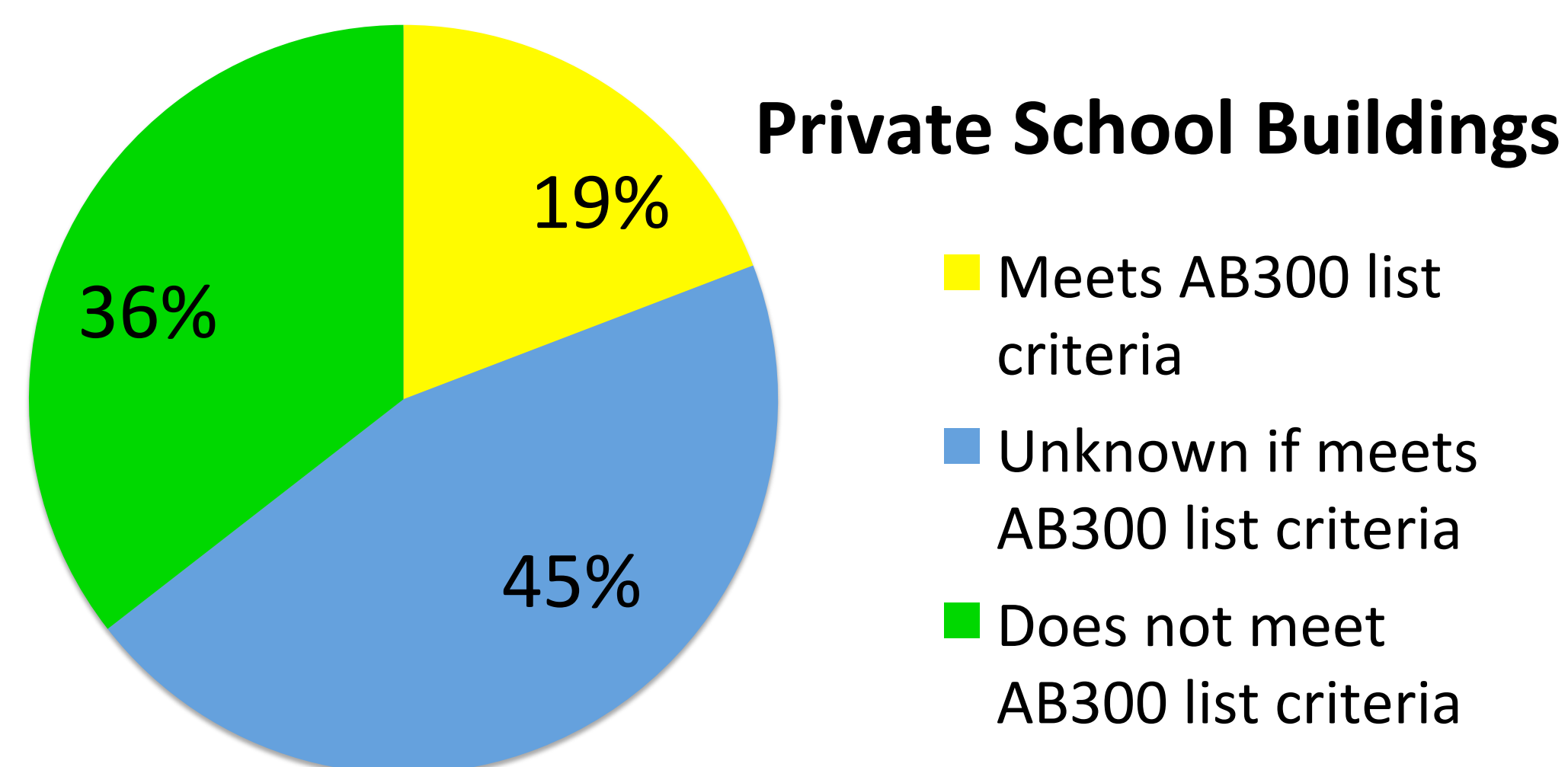
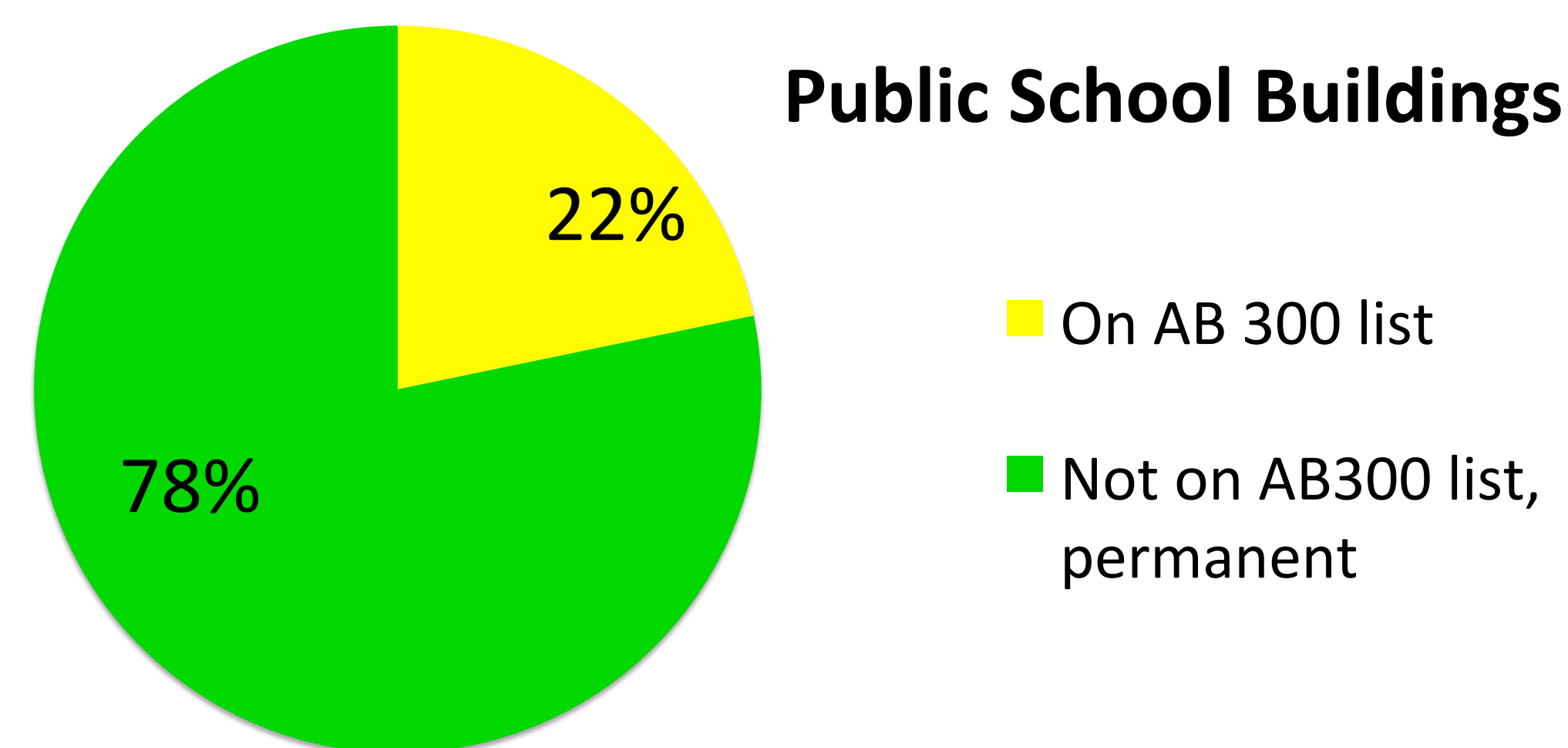

For the purpose of the working group unknowns are just as dangerous as buildings that meet the AB300 list criteria.

Conclusion

At the end of 2013, San Francisco Mayor Edwin Lee will receive a report from the private school working group giving recommendations. One of these recommendations will be a mandatory seismic evaluation for all private schools.

All children are entitled to equal protection, and parents have the right to know the structural condition of the school building in which they place their child.

Acknowledgements

I would like to thank PEER, especially Heidi Tremayne, and the NSF for granting me the opportunity to do this research. Special thanks goes to my mentor Laurence Kornfield and Laura Dwelley-Samant, whose guidance and experience were invaluable. Finally I would like to thank my fellow interns at PEER and the Epicenter.

San Francisco Property Information Maps, San Francisco Planning Department, Retrieved July 25, 2013 from <http://ec2-50-17-237-182.compute-1.amazonaws.com/PIM/Sanborn.html?sanborn=V4P355.PNG>